

FIXED-TIME APPLICATION TO APPROPRIATE WATER

STATE OF UTAH

Received By: CK#1240

Fee Amount: \$1000.00

Receipt: # 23-03530

For the purpose of acquiring the right to use a portion of the unappropriated water of the State of Utah, application is hereby made to the State Engineer, based upon the following showing of facts, submitted in accordance with the requirements of Title 73, Chapter 3, Utah Code Annotated 1953, as amended.

GH

Water Right:

(Document created on Jul 26, 2023 by LKANeko)

Water Right Number: 13-4097
(00-6158, LKANeko)

#A 83873

Owners:

Name: Waterleaf Resources LLC
Address: c/o Lilac Solutions
6975 Union Park Ave Suite 600
Cottonwood Heights UT 84047

Interest:

Remarks:

Dates:

Filed: 07/27/2023

Priority: 07/27/2023

General:

Quantity of Water: 225000 ACFT
Source: Great Salt Lake
County: Box Elder
Common Description: Promontory Point
Land Owned by Appl.: No

RECEIVED

JUL 27 2023

WATER RIGHTS
SALT LAKE

GH

County Tax Id#: 01-012-0160,01-012-0024, 03-008-0049

Points of Diversion:

Points of Diversion - Surface:

(1) S 917 ft. E 1610 ft. from W4 corner, Sec 11 T 6N R 6W SLBM

Diverting Works:

Source: N2I Northshore

Elevation:

UTM: 374416.962, 4568770.297 (NAD83)

(2) S 1077 ft. E 65 ft. from NW corner, Sec 25 T 6N R 6W SLBM

Diverting Works:

Source: A1I Allos 1 (south, near rail)

Elevation:

UTM: 375514.266, 4564677.847 (NAD83)

(3) S 3240 ft. W 633 ft. from N4 corner, Sec 31 T 9N R 7W SLBM

Diverting Works:

Source: N1I Mango

Elevation:

UTM: 358691.801, 4591290.318 (NAD83)

Water Uses:

Water Uses - Group Number: 892777

Water Use Types:

SCANNED GH

Other: Lithium Extraction

Period of Use: 01/01 to 12/31

Acre Feet Contributed by this Right for this Use: 225000

Place Of Use:

	North West				North East				South West				South East				Section Totals
	NW	NE	SW	SE	NW	NE	SW	SE	NW	NE	SW	SE	NW	NE	SW	SE	
Sec 11 T 6N R 6W SLBM													X	X	X	X	
Sec 11 T 6N R 6W SLBM	Lot 1																
Sec 11 T 6N R 6W SLBM	Lot 2																
Sec 11 T 6N R 6W SLBM	Lot 3																

Fixed Time

Place Of Use:

	North West				North East				South West				South East				Section Totals
	NW	NE	SW	SE	NW	NE	SW	SE	NW	NE	SW	SE	NW	NE	SW	SE	
Sec 14 T 6N R 6W SLBM																	X
Sec 31 T 9N R 7W SLBM				X			X										
Sec 31 T 9N R 7W SLBM	Lot 2																
Sec 31 T 9N R 7W SLBM	Lot 3																
Sec 31 T 9N R 7W SLBM	Lot 4																
Sec 31 T 9N R 7W SLBM	Lot 5																
Group Acreage Total :																	

Use Totals:

Other sole-supply total: 225000 acft

Other Comments:

This appropriation is for a fixed time, non-consumptive use of water for the extraction of lithium in an agreement with Forestry Fire and State Lands.

Once diverted, the water will be returned to the Great Salt Lake at a location to be determined so as to avoid commingling lithium rich brines with water exiting the facility without lithium.

This appropriation identifies several points of diversion as well as proposed places of beneficial use. Once the exact location is determined by the applicant, only one place of use and point of diversion will be retained and all other places of use and points of diversion will be abandoned.

This application is consistent with Gubernatorial Proclamation 2022-01, as issued by Governor Cox on November 3, 2022, as this application calls for a fixed time, non-consumptive use of water within the Great Salt Lake Basin. Although no water will be consumed by this fixed time application, the applicant intends to file a separate change application whereby applicants will deliver additional mitigation water to the Great Salt Lake as part of its desire to contribute to the enhancement of the Great Salt Lake.

Signature of Applicant:

The applicant hereby acknowledges that he/she is a citizen of the United States of America or intends to become such a citizen. The quantity of water sought to be appropriated is limited to that which can be beneficially used for the purposes herein described. The undersigned hereby acknowledges that even though he/she may have been assisted in the preparation of the above-numbered application through the courtesy of the employees of the Division of Water Rights, all responsibility for the accuracy of the information contained herein, including any maps and other documents attached, at the time of filing, rests with the applicant.

DocuSigned by:

Thomas Wilson
FOCBB207B0E54FE...



July 26, 2023

Waterleaf Resources LLC

SCANNED GH

Utah Water Right Application Map

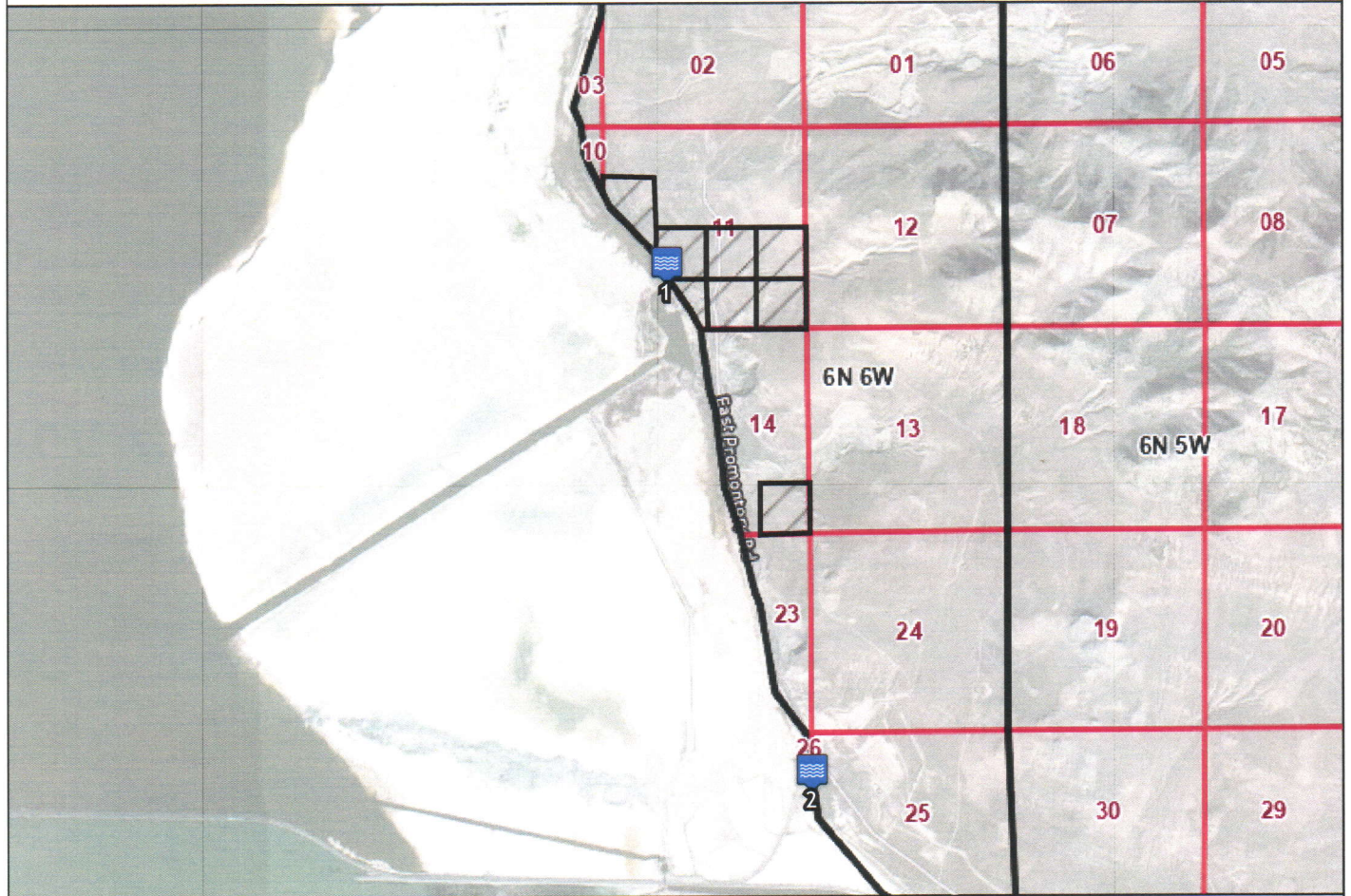

Legend



Place of use



Point of diversion

- (1) S 917 ft, E 1610 ft, from W4 cor, Sec 11, T 6N, R 6W, SL B&M (UTM-83: 374417, 4568770.3)
- (2) S 1077 ft, E 65 ft, from NW cor, Sec 25, T 6N, R 6W, SL B&M (UTM-83: 375514.3, 4564677.8)
- (3) S 3240 ft, W 633 ft, from N4 cor, Sec 31, T 9N, R 7W, SL B&M (UTM-83: 358691.8, 4591290.3)

I/we _____, hereby acknowledge that this map was prepared in support of Application E 93973. I/we hereby submit this map as a true representation of the facts shown thereon to the best of my/our knowledge and belief.

Applicant(s)

Date

SCANNED GH

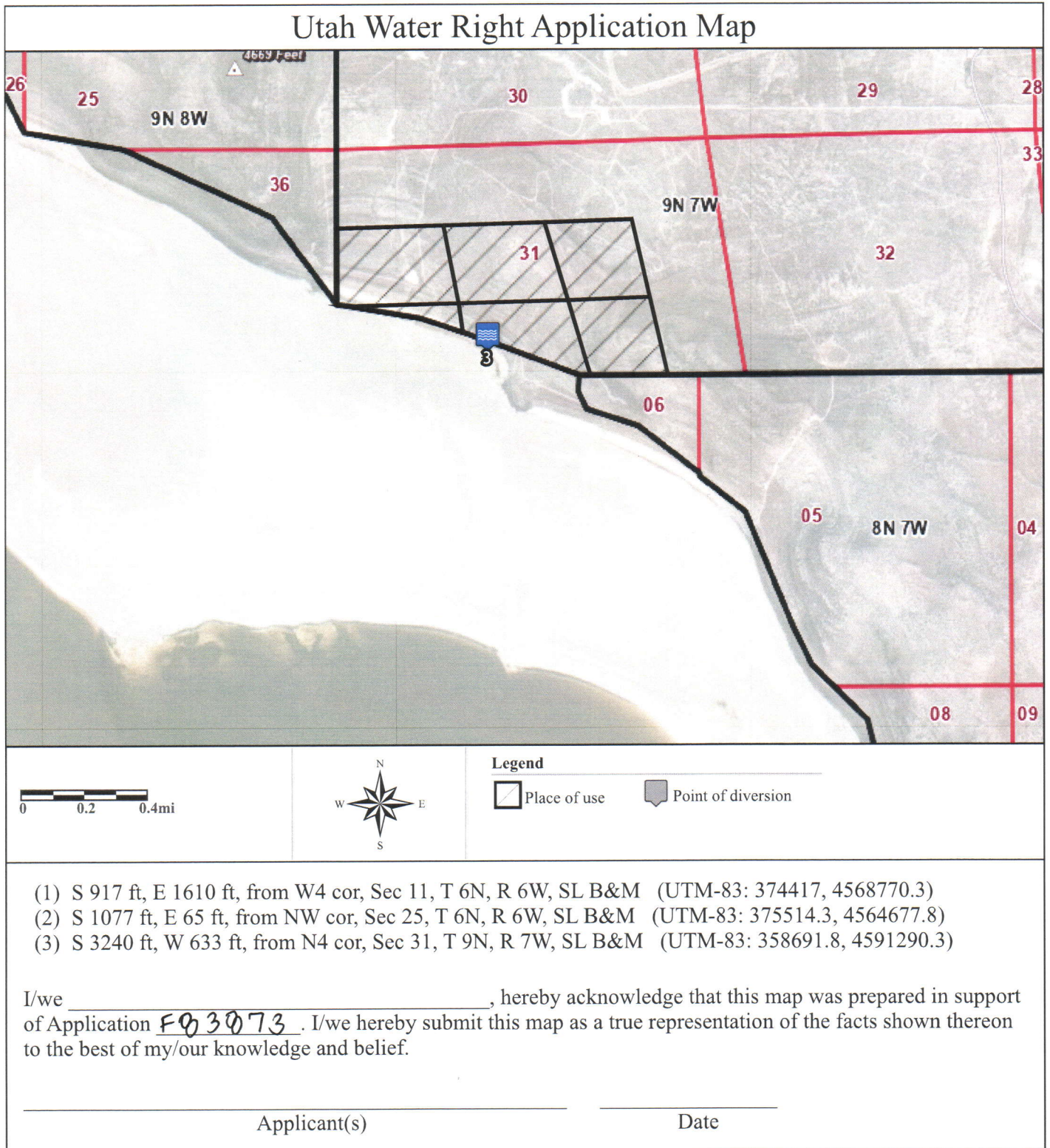

SCANNED GH